

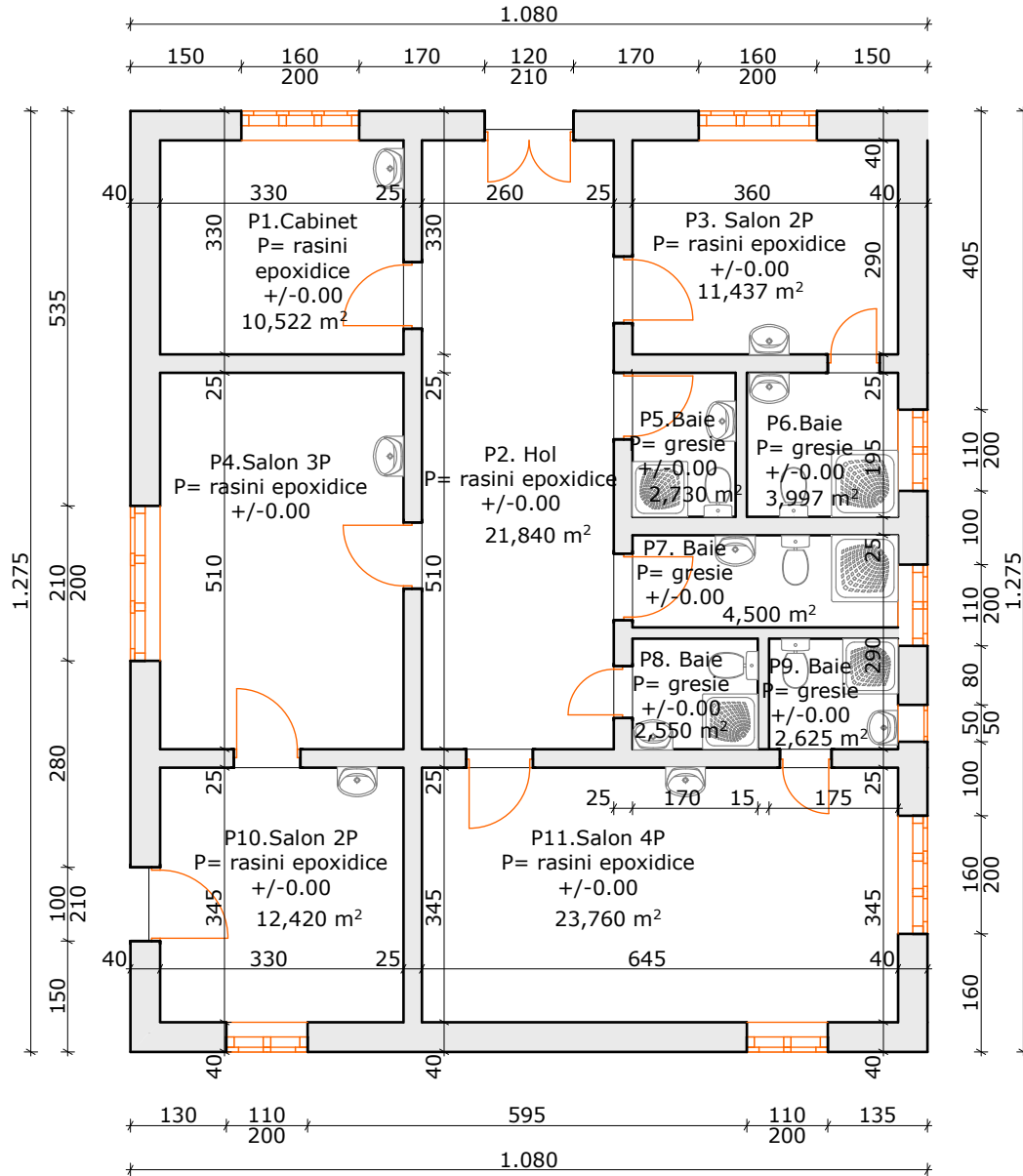

RELEVU - PLAN PSIHIATRIE



Verificator	Nume	Semnatura	Cerinta	Referat/Nr./Data
 S.C. STRADOR S.R.L. com Dornesti, nr.345, jud. Suceava c.u.i. 34674236,J33/560/2015 tel: 0746/109.193				SPITALUL MUNICIPAL SF. COSMA SI DAMIAN RADAUTI
SPECIFICATIE	SPECIFICATIE	SEMNATURA	SCARA 1:100	
SEF PROIECT	ing. Dunga D.			
RELEVAT	ing. Dunga D.			RELEVU - PLAN PSIHIATRIE
DESENAT	ing. Dunga D.			